



**NOVO CULT CHROME-PLATED**

height 1567 mm, lenght 500 mm. Chrome-plated finish (cod. 50).



**Technical features:**

- steel towel warmer radiator
- horizontal elements featuring round tubes 25 mm diameter
- side manifolds with semi-oval section 50x36,5 mm
- manifold threading and central connections (50 mm) 1/2" Gas right
- maximum working pressure 6 bar
- maximum working temperature 95°C

**Price included:**

- 4 chrome-plated wall fixing
- 1/2" chrome-plated air vent

**Extension of Guarantee**

Irsap guarantees only the hydraulic seal of NOVO CULT Chrome-plated radiators for 10 years, starting from sales in 2009.

The chrome plating is guaranteed for the period of time established by law, in any case not less than 24 months.

**Special options and surcharges:**

Radiators can be supplied with no. 1 1/2" coupling welded laterally for the connection to a single-pipe system and no. 2 1/2" couplings welded laterally to a manifold (Cod. B10). If the second coupling comes at a height that is lower than the half the radiator's total height, a diaphragm is welded inside to the manifold for optimized water circulation.

Surcharge for two 1/2" couplings welded to a lateral manifold and an internal diaphragm (**Cod. B10**)

Surcharge for two 1/2" couplings welded to a lateral manifold and an internal diaphragm (**Cod. B 99**)

Surcharge for one 1/2" coupling welded to a lateral manifold (**Cod. B12 left, Cod. B16 right**)

**CAUTION:** when this latter special working is present, correct operation is possible only when the lower outlet coupling is in axial alignment with the lowest pipe. Whenever this coupling is higher, all the pipes below will remain cold because they are not involved in the flow of water.

Finishes available	Surcharge
Chrome-plated	

**Connections**

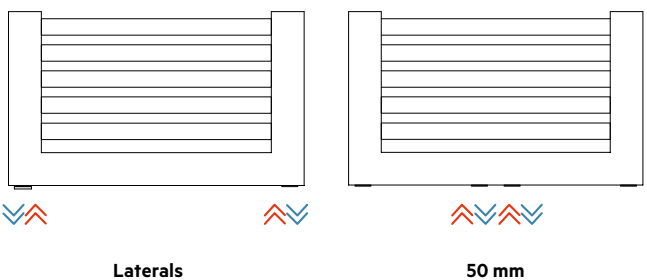

**Connection dimensions with IRSAP valves**

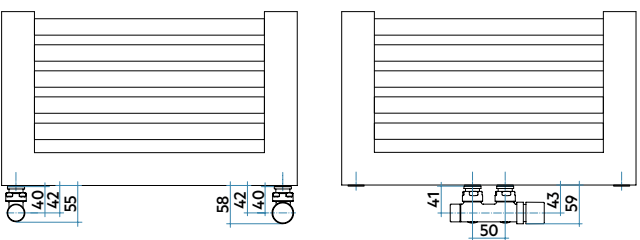

For other types of connections see pag. 414

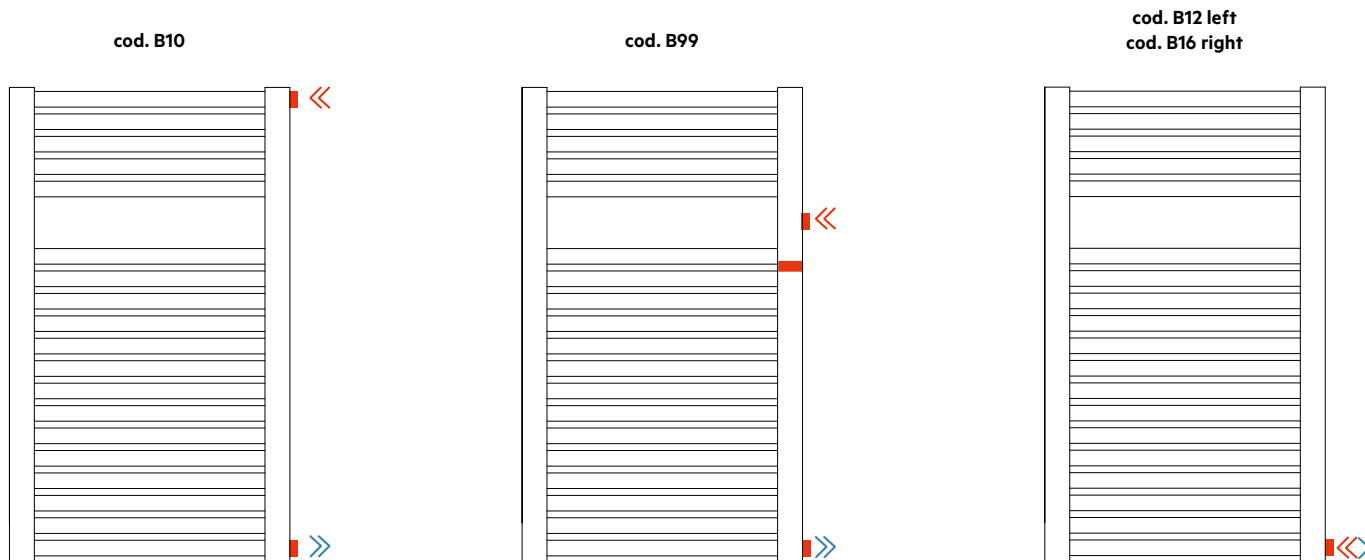

## Chrome-plated

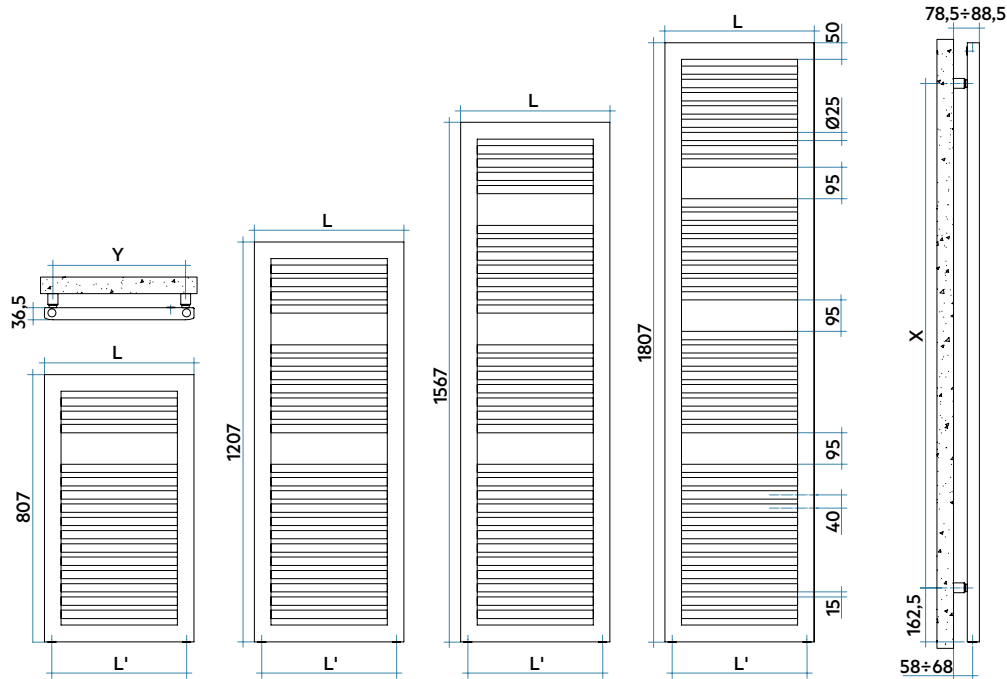

L mm	L' mm	Y mm
450	406	400
500	456	450
600	556	550

H mm	X mm
807	520
1207	920
1567	1280
1807	1520



Model	Code	Depth mm	Height mm	Width mm	Conn.		Weight Kg	Cap. lt	Thermal Power				
					centre	Weight			Δt=50°C	Δt=40°C	Δt=30°C	Δt=20°C	Exp.
									Watt	Watt	Watt (*)	Watt	n.
807 15 rails 1 espace	<b>NSS045 B 50 IR 01 NNN</b>	36,5	807	450	406	7,8	5,6	934	<b>274</b>	208	<b>146</b>	89	1,226
	<b>NSS050 B 50 IR 01 NNN</b>	36,5	807	500	456	8,4	6,1	1027	<b>301</b>	229	<b>161</b>	98	1,229
	<b>NSS060 B 50 IR 01 NNN</b>	36,5	807	600	556	9,6	7,0	1211	<b>355</b>	269	<b>189</b>	114	1,236
1207 23 rails 2 espaces	<b>NSM045 B 50 IR 01 NNN</b>	36,5	1207	450	406	11,0	8,0	1330	<b>390</b>	294	<b>205</b>	123	1,262
	<b>NSM050 B 50 IR 01 NNN</b>	36,5	1207	500	456	11,8	8,6	1457	<b>427</b>	322	<b>224</b>	135	1,260
	<b>NSM060 B 50 IR 01 NNN</b>	36,5	1207	600	556	13,5	9,9	1715	<b>503</b>	380	<b>264</b>	159	1,258
1567 30 rails 3 espaces	<b>NSL045 B 50 IR 01 NNN</b>	36,5	1567	450	406	13,9	10,1	1727	<b>506</b>	382	<b>265</b>	159	1,265
	<b>NSL050 B 50 IR 01 NNN</b>	36,5	1567	500	456	14,9	10,8	1896	<b>556</b>	419	<b>291</b>	175	1,264
	<b>NSL060 B 50 IR 01 NNN</b>	36,5	1567	600	556	16,9	12,4	2236	<b>655</b>	494	<b>344</b>	206	1,263
1807 36 rails 3 espaces	<b>NSE045 B 50 IR 01 NNN</b>	36,5	1807	450	406	16,0	11,7	2011	<b>589</b>	445	<b>310</b>	186	1,258
	<b>NSE050 B 50 IR 01 NNN</b>	36,5	1807	500	456	17,2	12,6	2216	<b>650</b>	491	<b>342</b>	206	1,255
	<b>NSE060 B 50 IR 01 NNN</b>	36,5	1807	600	556	19,6	14,4	2625	<b>769</b>	582	<b>406</b>	245	1,250

Mix. Funct.	Code
300	<b>ANRES300WDI50</b>
300	<b>ANRES300WDI50</b>
400	<b>ANRES400WDI50</b>
400	<b>ANRES400WDI50</b>
400	<b>ANRES400WDI50</b>
400	<b>ANRES400WDI50</b>
400	<b>ANRES400WDI50</b>
400	<b>ANRES400WDI50</b>
700	<b>ANRES700WDI50</b>
400	<b>ANRES400WDI50</b>
700	<b>ANRES700WDI50</b>
700	<b>ANRES700WDI50</b>

Electric heater for Dual Power

CHROME-PLATED RADIATORS

(\*) Thanks to the high performance of Irsap NOVO CULT CHROME-PLATED radiators, the ideal Δt for low temperature projects is Δt at 30°C.

For Δt different from 50°C use the formula:  $Q = Q_n (\Delta t / 50)^\alpha$

To order a radiator in the mixed version put the code of the Standard version + the code of the corresponding electric heater

Example: Mod. 1807 x 450: **NSE045 B 50 IR 01 NNN** (€ 1.411,00) + **ANRES400WDI50** (€ 175,13) = Tot. € 1.586,13

### Key Codes

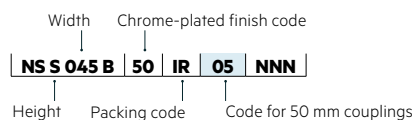
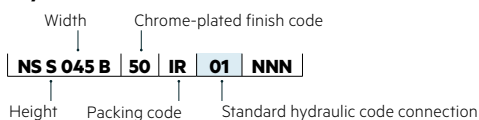

### Decorative & Technical Accessories

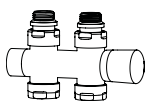

Kit Valves and Lockshield valve  
Pag. 562

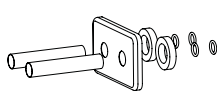

Pipe cover kit  
Pag. 566

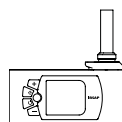

Electronic Control  
Pag. 574

