



**OASI**  
height 1290 mm, length 500 mm. Ivory finish (cod. 02).

**Technical features:**

- steel towel warmer radiator
- horizontal elements featuring 50x10 mm
- side manifolds 30x30 mm
- manifold threading 1/2" Gas right
- maximum working pressure 4 bar
- maximum working temperature 95°C

**Price included:**

- 4 wall fixing in the same color as the radiator
- 1/2" air vent

**Finishes available**

Standard White  
Classic finished  
Special finished  
Other RAL colors

**Surcharge**

Finishing codes see page 596.

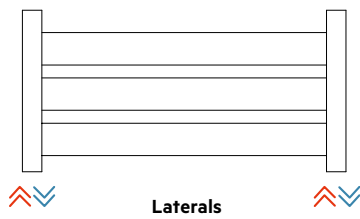
**Connections**

Laterals

For other types of connections see pag. 414

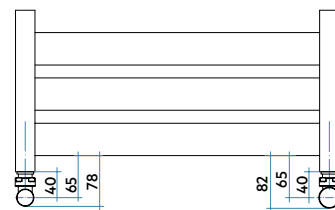
**Connection dimensions with IRSAP valves**

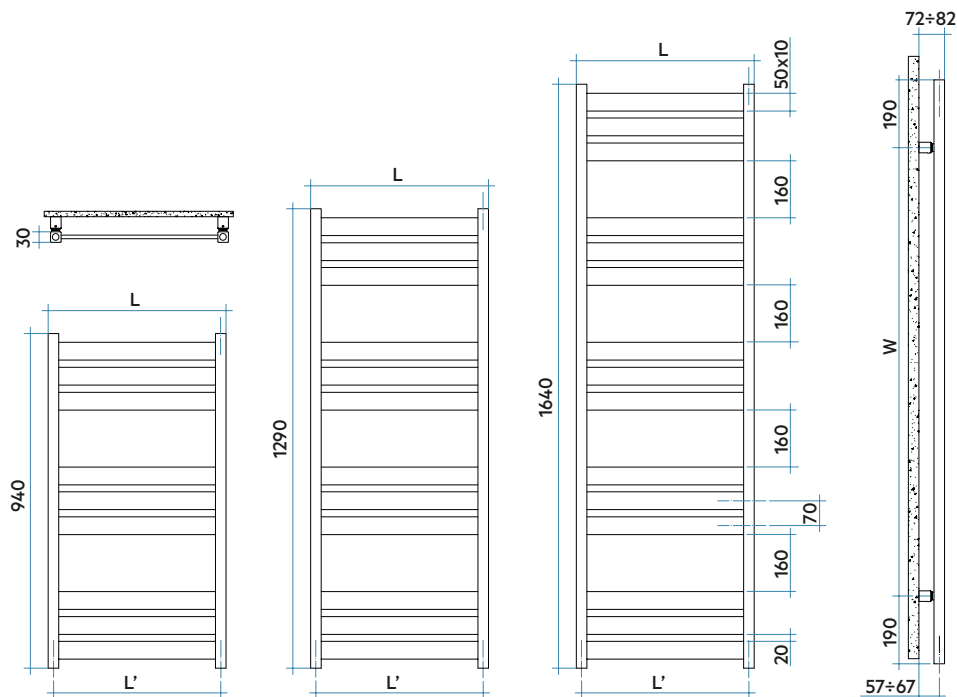

H mm	W mm	L mm	L' mm
940	560	500	470
1290	910	600	570
1640	1260		

Model	Code	Depth mm	Height mm	Width mm	Conn. centre mm	Weight Kg	Cap. lt	Thermal Power				Exp. n.	
								$\Delta t=50^{\circ}\text{C}$ Watt	$\Delta t=40^{\circ}\text{C}$ Watt	$\Delta t=30^{\circ}\text{C}$ Watt (*)	$\Delta t=20^{\circ}\text{C}$ Watt		
940 9 rails 2 espaces	ASH050 B 01 IR 01 NNN	30	940	500	470	7,3	2,7	1245	365	280	198	122	1,195
	ASH060 B 01 IR 01 NNN	30	940	600	570	8,7	3,1	1440	422	324	230	142	1,189
1290 12 rails 3 espaces	ASH050 B 01 IR 01 NNN	30	1290	500	470	9,8	3,9	1669	489	374	264	162	1,204
	ASH060 B 01 IR 01 NNN	30	1290	600	570	11,7	4,5	1928	565	432	305	187	1,205
1640 15 rails 4 espaces	ASC050 B 01 IR 01 NNN	30	1640	500	470	12,4	4,7	2143	628	479	337	206	1,218
	ASC060 B 01 IR 01 NNN	30	1640	600	570	14,9	5,4	2491	730	556	391	239	1,220



Mix. Funct.	Code
400 Watt	ANRES400WDI
400 Watt	ANRES400WDI
400 Watt	ANRES400WDI
700 Watt	ANRES700WDI
700 Watt	ANRES700WDI
700 Watt	ANRES700WDI

Electric heater for Dual Power

BATHROOMS RADIATORS

(\*) Thanks to the high performance of Irsap OASI radiators, the ideal  $\Delta t$  for low temperature projects is  $\Delta t$  at  $30^{\circ}\text{C}$ .

For  $\Delta t$  different from  $50^{\circ}\text{C}$  use the formula:  $Q=Q_n (\Delta t / 50)^n$

To order a radiator in the mixed version put the code of the Standard version + the code of the corresponding electric heater

Example: Mod. 1290 x 600: **ASH060 B 01 IR 01 NNN** (€ 189,00) + **ANRES700WDI** (€ 122,38) = Tot. € 311,38

### Key Codes

AS	1050 B	01	IR	01	NNN
Height	Width	Packing code	Standard White colour code - for different colour codes see the colors page	Standard hydraulic code connection	

### Decorative & Technical Accessories

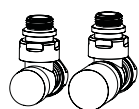

Kit Valves and Lockshield valve  
Pag. 562

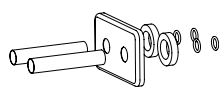

Pipe cover kit  
Pag. 566

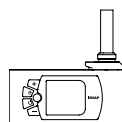

Electronic Control  
Pag. 574

